

## ▼ RC Universal Single-Acting Cylinders

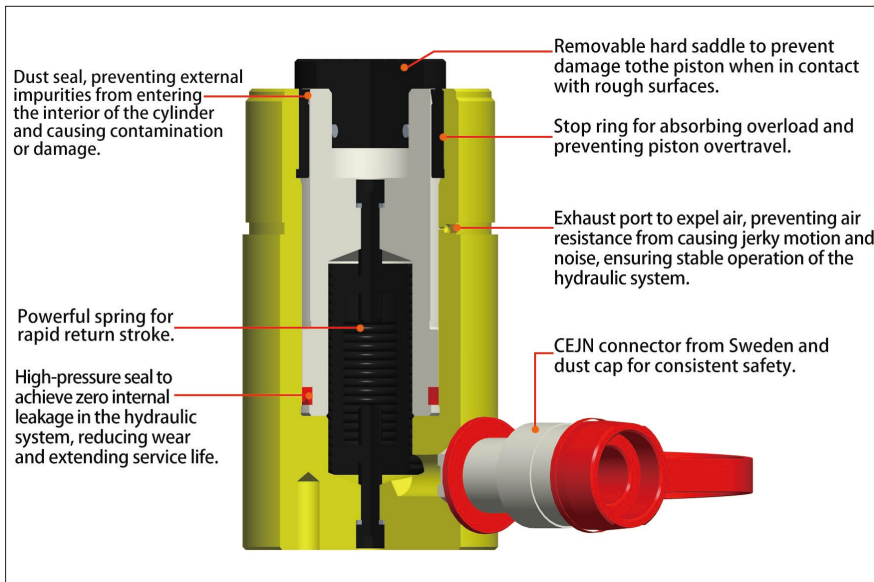

- Reinforced-design stop ring enhances durability and anti-eccentric load capacity
- High-tonnage cylinders are equipped with certified G80 high-strength lifting eyes
- All models are equipped with base mounting holes
- Pre-tensioned spring system enables faster retraction speed
- High-grade polyurethane seals are adopted, featuring excellent sealing performance, wear resistance, and a long service life
- Plunger dust seals can reduce contamination issues and prolong the service life of hydraulic cylinders
- Preset outer ring threads, plunger threads, and base mounting holes simplify connection and installation
- Suitable for all installation positions and orientations
- Equipped with a breather port for smooth extension and fast retraction
- Stove enamel surface treatment offers exceptional corrosion resistance.

### ▼ RC Performance Introduction:



Rated Pressure: 70MPa

Rated Tonnage: 5-95ton

Stroke Range: 16-362mm

► Note:

- RC50 cylinder has a non-removable grooved saddle and no collar thread.
- RC50: D1 = 41 mm, L = 20 mm, M = 25 mm.
- RC101 has plunger with two thread holes and non-removable saddle.

Capacity (ton (kN))	Stroke (mm)	Model Number	Cylinder Effective Area (cm <sup>2</sup> )	Oil Capacity (cm <sup>3</sup> )	Collapsed Height A (mm)	Extended Height B (mm)
5 (45)	16	RC50	6.4	10	41	57
	25	RC51	6.4	16	110	135
	79	RC53	6.4	50	165	244
	127	RC55	6.4	83	216	343
	177	RC57	6.4	115	273	450
10 (101)	232	RC59	6.4	151	324	556
	26	RC101	14.4	38	90	116
	54	RC102	14.4	78	121	175
	105	RC104	14.4	152	171	276
	156	RC106	14.4	226	248	404
	203	RC108	14.4	294	298	501
15 (142)	257	RC1010	14.4	373	349	606
	304	RC1012	14.4	441	400	704
	356	RC1014	14.4	516	451	807
	25	RC151	20.3	51	124	149
	51	RC152	20.3	104	149	200
	101	RC154	20.3	205	200	301
	152	RC156	20.3	308	271	423
25 (232)	203	RC158	20.3	411	322	525
	254	RC1510	20.3	516	373	627
	305	RC1512	20.3	619	424	729
	356	RC1514	20.3	723	475	831
	26	RC251	33.3	86	140	166
	50	RC252	33.3	166	165	215
	102	RC254	33.3	339	216	318
30 (295)	158	RC256	33.3	525	273	431
	210	RC258	33.3	697	324	534
	261	RC2510	33.3	867	375	636
	311	RC2512	33.3	1033	425	736
	362	RC2514	33.3	1202	476	838
50 (498)	209	RC308	42.9	880	387	596
	51	RC502	71.3	362	176	227
	101	RC504	71.3	719	227	328
	159	RC506	71.3	1131	283	442
75 (718)	260	RC5010	71.3	1855	384	644
	337	RC5013	71.3	2399	460	797
	156	RC756	102.6	1601	286	442
95 (933)	333	RC7513	102.6	3417	492	825
	51	RC1002	133.1	676	219	270
	168	RC1006	133.1	2239	357	525
	260	RC10010	133.1	3466	449	709

## ▼ RC Outline Dimensional

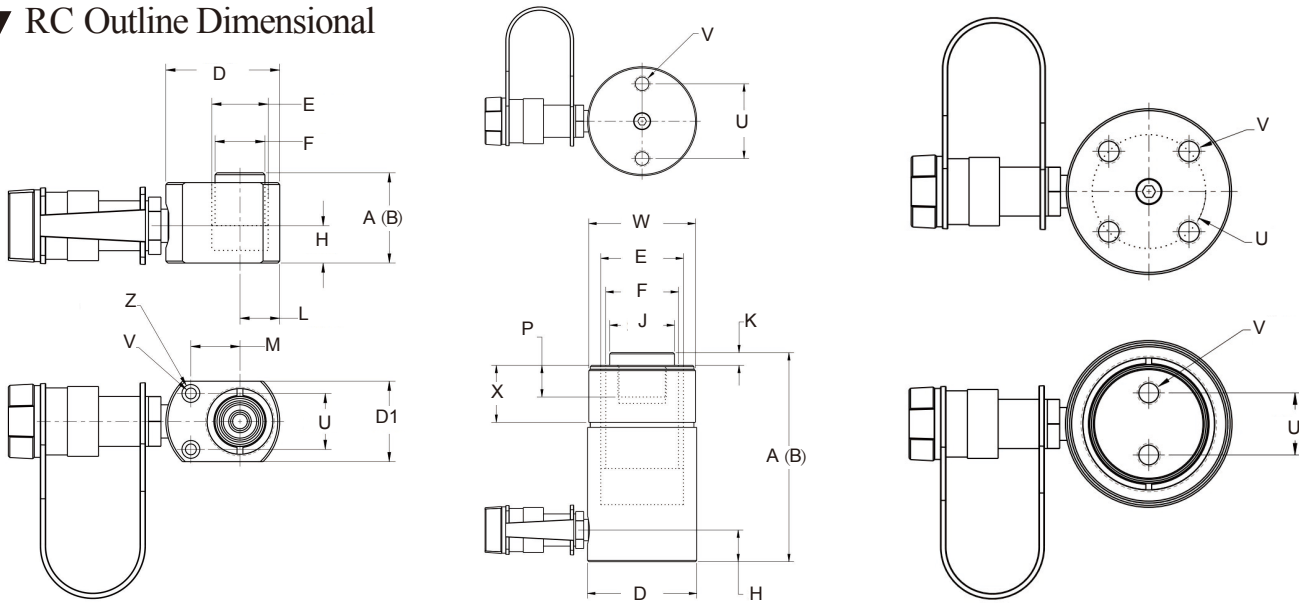

Outside Dia. D (mm)	Bore Dia. E (mm)	Plunger Dia. F (mm)	Base to Adv. Port H (mm)	Saddle Dia. J (mm)	Saddle Prot. from Plgr. K (mm)	Plunger Internal Thread O	Plunger Thread Length P (mm)	Steel Base Plate Mounting Holes			Base Mounting Holes - Thread W	Collar Thread Length X (mm)	Weight (KG)	Model Number
								Bolt Circle U(mm)	Thread V(mm)	Thread Depth Y(mm)				
58	28.6	25.40	19	25	6	—	14	29	¼" - 20 UNC	14	½" - 16 UN	28	1	RC50
38	28.6	25.40	19	25	6	¾" - 16 UN	14	25	¼" - 20 UNC	14	½" - 16 UN	28	1.5	RC51
38	28.6	25.40	19	25	6	¾" - 16 UN	14	25	¼" - 20 UNC	14	½" - 16 UN	28	1.9	RC53
38	28.6	25.40	19	25	6	¾" - 16 UN	14	25	¼" - 20 UNC	14	½" - 16 UN	28	2.4	RC55
38	28.6	25.40	19	25	6	¾" - 16 UN	16	25	¼" - 20 UNC	14	½" - 16 UN	28	2.8	RC57
38	28.6	25.40	19	25	6	¾" - 16 UN	16	25	⅝" - 18 UNC	12	¾" - 14 UN	28	2.8	RC59
57	42.8	38.10	19	35	6	#10 - 24 UN	6	40	⅝" - 18 UNC	12	¾" - 14 UN	27	1.8	RC101
57	42.8	38.10	19	35	6	1" - 8 UN	19	40	⅝" - 18 UNC	12	¾" - 14 UN	27	2.3	RC102
57	42.8	38.10	19	35	6	1" - 8 UN	19	40	⅝" - 18 UNC	12	¾" - 14 UN	27	3.3	RC104
57	42.8	38.10	19	35	6	1" - 8 UN	19	40	⅝" - 18 UNC	12	¾" - 14 UN	27	4.4	RC106
57	42.8	38.10	19	35	6	1" - 8 UN	19	40	⅝" - 18 UNC	12	¾" - 14 UN	27	5.4	RC108
57	42.8	38.10	19	35	6	1" - 8 UN	19	40	⅝" - 18 UNC	12	¾" - 14 UN	27	6.4	RC1010
57	42.8	38.10	19	35	6	1" - 8 UN	19	40	⅝" - 18 UNC	12	¾" - 14 UN	27	6.8	RC1012
57	42.8	38.10	19	35	6	1" - 8 UN	19	40	⅝" - 18 UNC	12	¾" - 16 UN	27	8.2	RC1014
70	50.8	41.30	19	38	9	1" - 8 UN	25	48	⅝" - 16 UNC	12	¾" - 16 UN	30	3.3	RC151
70	50.8	41.30	19	38	9	1" - 8 UN	25	48	⅝" - 16 UNC	12	¾" - 16 UN	30	4.1	RC152
70	50.8	41.30	19	38	9	1" - 8 UN	25	48	⅝" - 16 UNC	12	¾" - 16 UN	30	5	RC154
70	50.8	41.30	25	38	9	1" - 8 UN	25	48	⅝" - 16 UNC	12	¾" - 16 UN	30	6.8	RC156
70	50.8	41.30	25	38	9	1" - 8 UN	25	48	⅝" - 16 UNC	12	¾" - 16 UN	30	8.2	RC158
70	50.8	41.30	25	38	9	1" - 8 UN	25	48	⅝" - 16 UNC	12	¾" - 16 UN	30	9.5	RC1510
70	50.8	41.30	25	38	9	1" - 8 UN	25	48	⅝" - 16 UNC	12	¾" - 16 UN	30	10.9	RC1512
70	50.8	41.30	25	38	9	1" - 8 UN	25	48	½" - 13 UNC	19	3⅝" - 12 UN	30	11.8	RC1514
86	65.1	57.20	25	51	10	1½" - 16 UN	25	59	½" - 13 UNC	19	3⅝" - 12 UN	49	5.9	RC251
86	65.1	57.20	25	51	10	1½" - 16 UN	25	59	½" - 13 UNC	19	3⅝" - 12 UN	49	6.4	RC252
86	65.1	57.20	25	51	10	1½" - 16 UN	25	59	½" - 13 UNC	19	3⅝" - 12 UN	49	8.2	RC254
86	65.1	57.20	25	51	10	1½" - 16 UN	25	59	½" - 13 UNC	19	3⅝" - 12 UN	49	10	RC256
86	65.1	57.20	25	51	10	1½" - 16 UN	25	59	½" - 13 UNC	19	3⅝" - 12 UN	49	12.2	RC258
86	65.1	57.20	25	51	10	1½" - 16 UN	25	59	½" - 13 UNC	19	3⅝" - 12 UN	49	14.1	RC2510
86	65.1	57.20	25	51	10	1½" - 16 UN	25	59	½" - 13 UNC	19	3⅝" - 12 UN	49	16.3	RC2512
86	65.1	57.20	25	51	10	1½" - 16 UN	25	59	½" - 13 UNC	16	3⅝" - 12 UN	49	17.7	RC2514
102	73	59.20	23	51	10	1½" - 16 UN	25	59	½" - 13 UNC	19	5" - 12 UN	49	15.1	RC308
127	95.2	79.40	39	71	2	—	—	95	½" - 13 UNC	19	5" - 12 UN	55	18	RC502
127	95.2	79.40	33	71	2	—	—	95	½" - 13 UNC	19	5" - 12 UN	55	19.1	RC504
127	95.2	79.40	35	71	2	—	—	95	½" - 13 UNC	19	5" - 12 UN	55	23.1	RC506
127	95.2	79.40	35	71	2	—	—	95	½" - 13 UNC	19	5" - 12 UN	55	31.8	RC5010
127	95.2	79.40	35	71	2	—	—	95	⅝" - 13 UNC	16	5¾" - 12 UN	55	37.6	RC5013
146	114.3	95.30	30	71	2	—	—	114	⅝" - 13 UNC	16	5¾" - 12 UN	44	29.5	RC756
146	114.3	95.30	30	71	2	—	—	114	¾" - 10 UNC	25	6⅝" - 12 UN	44	59	RC7513
178	130.2	104.80	41	71	2	—	—	140	¾" - 10 UNC	25	6⅝" - 12 UN	44	36.7	RC1002
178	130.2	104.80	41	71	2	—	—	140	¾" - 10 UNC	25	6⅝" - 12 UN	44	59	RC1006
178	130.2	104.80	41	71	2	—	—	140	¾"-10 UNC	25	6⅝"-12 UN	44	72.6	RC10010