

▼ RACL Aluminum Lock Nut Cylinder



Rated Pressure: 70MPa

Rated Tonnage: 20-150ton

Stroke Range: 50-250mm



Removable Saddle
All RACL hydraulic cylinders are equipped heavy-duty removable saddles.

- Aluminum lock nut: Enables long-term mechanical load holding to ensure stable load support.
- Hardened steel retaining ring: Extends cylinder service life and withstands lateral load up to 5% of rated load.
- Hard coat surface treatment: Applied to all surfaces for superior wear and damage resistance, greatly prolonging service life.
- Composite bearing: Improves durability and lateral load resistance.
- Standard lifting handle: Fitted across the full range for easy handling and on-site operation.
- Steel base plate and saddle: Resists structural damage under load and enhances operational reliability.
- Integrated stop ring: Prevents plunger overtravel and sustains full rated load for operational safety.
- High-strength return spring: Delivers rapid retraction and boosts working efficiency.
- Standard coupling and dust cap: All models come with CEJN quick couplings and dust caps.

Cylinder Capacity @ 700 bar (ton (kN))	Stroke (mm)	Model Number	Cylinder Effective Area (cm ²)	Oil Capacity (cm ³)
20 (218)	50	RACL202	31.2	156
20 (218)	100	RACL204	31.2	312
20 (218)	150	RACL206	31.2	468
20 (218)	200	RACL208	31.2	624
20 (218)	250	RACL2010	31.2	780
30 (309)	50	RACL302	44.2	221
30 (309)	100	RACL304	44.2	442
30 (309)	150	RACL306	44.2	663
30 (309)	200	RACL308	44.2	883
30 (309)	250	RACL3010	44.2	1105
50 (496)	50	RACL502	70.9	354
50 (496)	100	RACL504	70.9	709
50 (496)	150	RACL506	70.9	1063
50 (496)	200	RACL508	70.9	1417
50 (496)	250	RACL5010	70.9	1771
100 (1002)	50	RACL1002	143.1	716
100 (1002)	100	RACL1004	143.1	1431
100 (1002)	150	RACL1006	143.1	2147
100 (1002)	200	RACL1008	143.1	2863
100 (1002)	250	RACL10010	143.1	3578
150 (1589)	50	RACL1502	227	1135
150 (1589)	100	RACL1504	227	2270
150 (1589)	150	RACL1506	227	3405
150 (1589)	200	RACL1508	227	4540
150 (1589)	250	RACL15010	227	5675

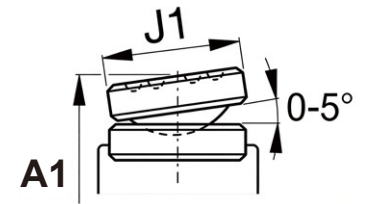
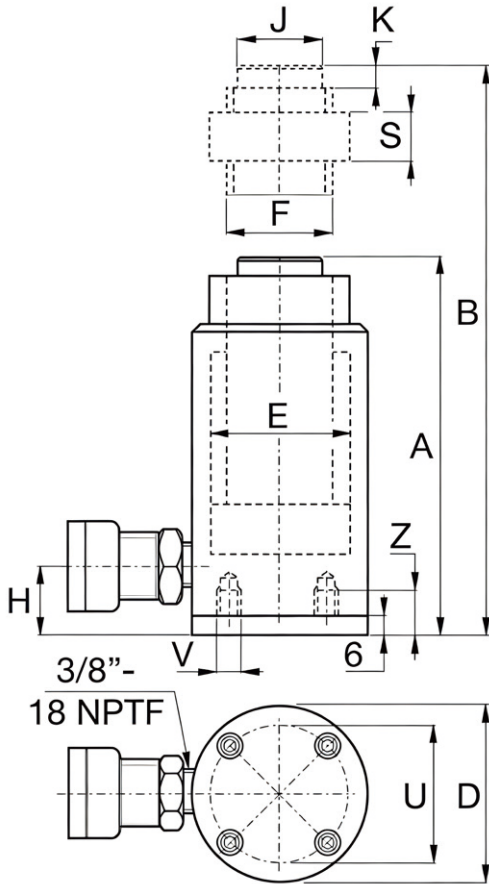

▼ Dimensions of Optional Bolt-on Tilt Saddle

For Cylinder Model / Capacity ton	Tilt Saddle Model Number	Tilt Saddle Diameter J1 (mm)	Addition to Collapsed Height A1 (mm)
RACL20, 30	CATS30	55	11
RACL50	CATS50	71	14
RACL100	CATS150	97	19
RACL150	CATS200	126	18

▼ Steel Base Plate Mounting Holes

Cylinder Model / Capacity (ton)	Bolt Circle U (mm)	Thread V (mm)	Thread Depth Z (mm)
RACL20	70	M6	12
RACL30	80	M6	12
RACL50	110	M6	12
RACL100	150	M10	12
RACL150	200	M10	12

◆ Includes base plate with a height of 6 mm

Collapsed Height A (mm)	Extended Height B (mm)	Outside Diameter D (mm)	Cylinder Bore Diameter E (mm)	Plunger Diameter (Threaded) F (mm)	Bottom to Advance Port H (mm)	Saddle Diameter J (mm)	Saddle Protrusion from Plunger K (mm)	Lock Nut Height S (mm)	Weight (kg)	Model Number
224	274	85	63	Tr 55 x 4	27	40	3	50	4	RACL202
274	374	85	63	Tr 55 x 4	27	40	3	50	4.6	RACL204
324	474	85	63	Tr 55 x 4	27	40	3	50	5.2	RACL206
374	574	85	63	Tr 55 x 4	27	40	3	50	5.8	RACL208
424	674	85	63	Tr 55 x 4	27	40	3	50	6.4	RACL2010
231	281	100	75	Tr 60 x 4	33	40	3	50	5.4	RACL302
281	381	100	75	Tr 60 x 4	33	40	3	50	6.1	RACL304
331	481	100	75	Tr 60 x 4	33	40	3	50	6.8	RACL306
381	581	100	75	Tr 60 x 4	33	40	3	50	7.5	RACL308
431	681	100	75	Tr 60 x 4	33	40	3	50	8.2	RACL3010
236	286	130	95	Tr 80 x 4	30	50	3	50	9.3	RACL502
286	386	130	95	Tr 80 x 4	30	50	3	50	10.6	RACL504
336	486	130	95	Tr 80 x 4	30	50	3	50	12.6	RACL506
386	586	130	95	Tr 80 x 4	30	50	3	50	13.2	RACL508
436	686	130	95	Tr 80 x 4	30	50	3	50	14.5	RACL5010
296	346	180	135	Tr 110 x 6	46	94	3	75	21.9	RACL1002
346	446	180	135	Tr 110 x 6	46	94	3	75	24.2	RACL1004
396	546	180	135	Tr 110 x 6	46	94	3	75	26.5	RACL1006
446	646	180	135	Tr 110 x 6	46	94	3	75	28.8	RACL1008
496	746	180	135	Tr 110 x 6	46	94	3	75	31.1	RACL10010
323	373	230	170	Tr 140 x 6	51	113	3	80	32.2	RACL1502
373	473	230	170	Tr 140 x 6	51	113	3	80	36.2	RACL1504
423	573	230	170	Tr 140 x 6	51	113	3	80	40.2	RACL1506
473	673	230	170	Tr 140 x 6	51	113	3	80	44.2	RACL1508
523	773	230	170	Tr 140 x 6	51	113	3	80	48.2	RACL15010