

FS系列, 液压法兰分离器

FS-Series, Hydraulic Flange Spreaders

RIVERLAKE®



- 轻型宜人的设计便易使用
- 从70-216mm的可调尖端宽度, 应用范围广
- 单作用、弹簧回位RC-系列液压缸利于快捷、无故障操作
- Lightweight, ergonomic design for ease of use
- Adjustable jaw widths from 70 mm to 216 mm for a wide range of applications
- Single-acting, spring return RC-Series cylinders for fast trouble-free operation.



最大法兰厚度 Maximum Flange Thickness (mm)	螺栓尺寸 Stud Size (mm)	标准楔 Standard Wedge (mm)	工作能力 Capacity (ton)	行程 Stroke (mm)	油容量 Oil Capacity (cm ³)	型号 Model Number	Dimensions 尺寸 (mm)											
							C		D	E	F	H	I	J				
							Min.	Max.										
2 x 57	19 - 28	3 - 28	5	38	24.6	FS-56	76	209	70	155	32	196	88	25	206	19	11.5	
2 x 92	31 - 41	3 - 28	10	54	78.7	FS-109	108	279	104	216	50	152	114	38	273	31	18.1	

工作能力:
Capacity: **5 - 10ton**

扩张宽度:
Spread: **70-216mm**

最大工作压力:
Maximum Operating Pressure: **700 bar**



液压法兰破切器可成套提供(泵、工具、压力表、压力表适配器、接头以及软管), 方便订购。
The hydraulic flange spreader is available as set (pump, tool, gauge, gauge adaptor, couplers and hose) for your ordering convenience.

尖端厚度/最大分开距离:
Tip Clearance / Maximum Spread: **6mm/81mm**

最大分离力:
Maximum Spread Force: **8-14ton**

最大工作压力:
Maximum Operating Pressure: **700 bar**
(FSH-14)

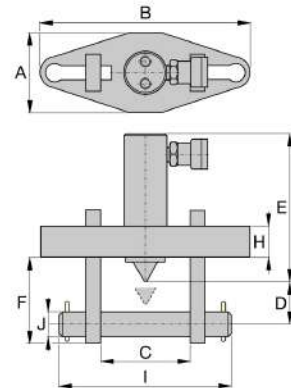

台阶垫块FSB-1
使用台阶垫块可将法兰分离器开口距离增加至81mm, 可与FSH-14和FSM-8配合使用。

Stepped Blocks FSB-1
Use stepped blocks to increase wedge opening up to 80 mm. Fits both FSH-14 and FSM-8.



与FSH-14法兰分离器一起分离并维修法兰。
Separate and repair flange with FSH-14 flange separator.

液压与机械法兰分离器

Hydraulic and Mechanical Wedge Spreaders

RIVERLAKE®



- 适用于维护、检修、测试和阀门更换应用
- 整体分离楔概念: 无摩擦、平行平滑运动, 消除法兰损伤和分离楔损坏的危险
- 独特的互锁楔子设计 - 第一级无弯曲无滑脱危险
- 插入口要求仅为6mm
- 台阶形张臂的设计使每格台阶可承受满负荷
- 较少的运动部件, 经久耐用, 维护方便
- For maintenance, commissioning, shutdowns, testing and valve change outs
- Integrated wedge concept: Friction-free, smooth and parallel wedge movement eliminates flange damage and spreading arm failure
- Unique interlocking wedge design - no first step bending and risk of slipping out of joint
- Requires very small access gap of only 6 mm
- Stepped spreader arm design - each step can spread under full load
- Few moving parts mean durability and low maintenance

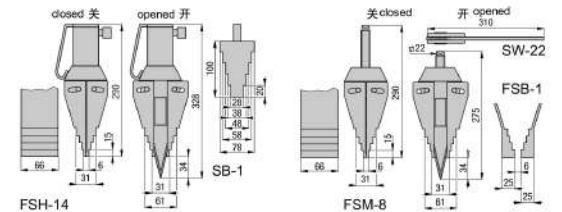

最大分离力 Maximum Spreading Force ton (kN)	厚度 Model Number	尖端厚度 Tip Clearance (mm)	最大分距 ¹⁾ Maximum Spread ¹⁾ (mm)	类型 Spreader Type	油容积 Oil Capacity (cm ³)	
14 (125)	FSH-14*	6	81	液压式 Hydraulic	78	7.1
8 (72)	FSM-8	6	81	机械式 Mechanical	-	6.5

¹⁾ 使用台阶垫块 FSB-1
¹⁾ Using stepped blocks FSB-1
* Available as pump-tool set, see note on this page.

液压提升器 Hydraulic Spreader

RIVERLAKE®



最大顶升能力: Maximum Lifting Force:	16 ton (157kN)
顶升行程: Lifting Stroke:	21mm
最小间隙/最大顶升高度: Tip Clearance/Maximum Spread*:	10mm/81.5mm
最大工作压力: Maximum Operating Pressure:	700 bar

- 最小安装间隙10mm
- 700bar压力时顶升力16吨
- 每一阶梯都可以满负荷承载
- 垂直顶升
- 独一无二的联锁楔形设计
- 单作用、弹簧复位
- 包括安全垫块 SB-2
- Requires very small access gap of only 10mm
- Lifting force 16 ton at 700 bar hydraulic pressure
- Straight vertical lifting
- Unique interlocking wedge design: no first step bending and risk of slipping out
- Single-acting, spring return cylinder
- Lifting wedge LW-16 includes safety block SB-2

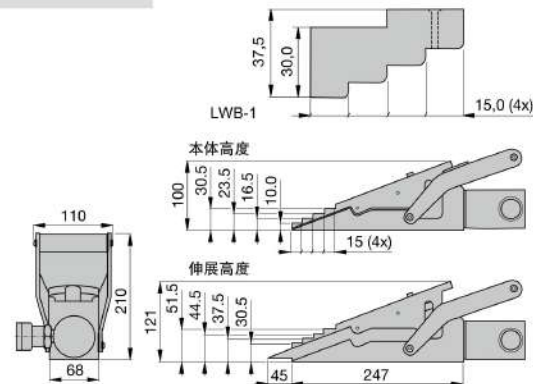

For lifting heavy equipment with minimum floor clearance the LW-16 is the ideal tool.
LW-16适用于狭小空间顶升重型设备。

最大顶升压力 Maximum Lifting Force	行程 Lifting Stroke	型号 Model Number	最小间隙 Tip Clearance	最大工作压力 Maximum Operating Pressure	油量 Oil Capacity	重量 Weight
ton (kN)	(mm)		(mm)	(bar)	(cm ³)	(kg)
16 (157)	21	LW-16	10	700	78	9.0

使用台阶垫块LWB-1, 可增加顶升高度30mm。

*使用 LWB-1。
Use optional stepped block LWB-1 to increase wedge lifting height by 30 mm.
• Using LWB-1.

